

LEGEND

- B1** ESSC 2007 BORING BY ESSC, 2007
- TP-10** ESSC 2007 TEST PIT BY ESSC, 2007
- TP-6** PSE 1995 TEST PIT BY PIONEER SOILS ENGINEERING, 1995
- TP-2** ESSC 2007 TEST PIT BY ESSC, 2007

- B2** ESSC 2003 BORING BY ESSC, 2003
- TP1** ESSC 2003 TEST PIT BY ESSC, 2003
- TP1** ESSC 2004 TEST PIT BY ESSC, 2004

- TP1** PSE 1995 TEST PIT BY PIONEER SOILS ENGINEERING, 1995

- TP1** TEST PIT BY KOVACS, BYER, 1991

- STRIKE AND DIP OF JOINT
- STRIKE AND DIP OF FOLIATION

- TP-1** TEST PIT BY NUNEZ ENGINEERING, 1983, 1989
- STRIKE AND DIP OF JOINT
- STRIKE AND DIP OF FOLIATION

- TP4** TEST PIT BY THE J. BYER GROUP INC., 2004
- TP-4** TEST PIT BY THE J. BYER GROUP INC., 1993

GEOLOGIC CONTACT
 Dashed Where Approximate, Dotted Where Concealed, Querried Where Uncertain

QUATERNARY

- Qa** QUATERNARY ALLUVIUM
- Qc** COLLUVIUM

MESOZOIC

- qd** QUARTZ DIORITE BEDROCK

BASE MAP OBTAINED FROM 3DI WEST.

APPROXIMATE SCALE
1 in = 100 ft



APPROXIMATE NORTH

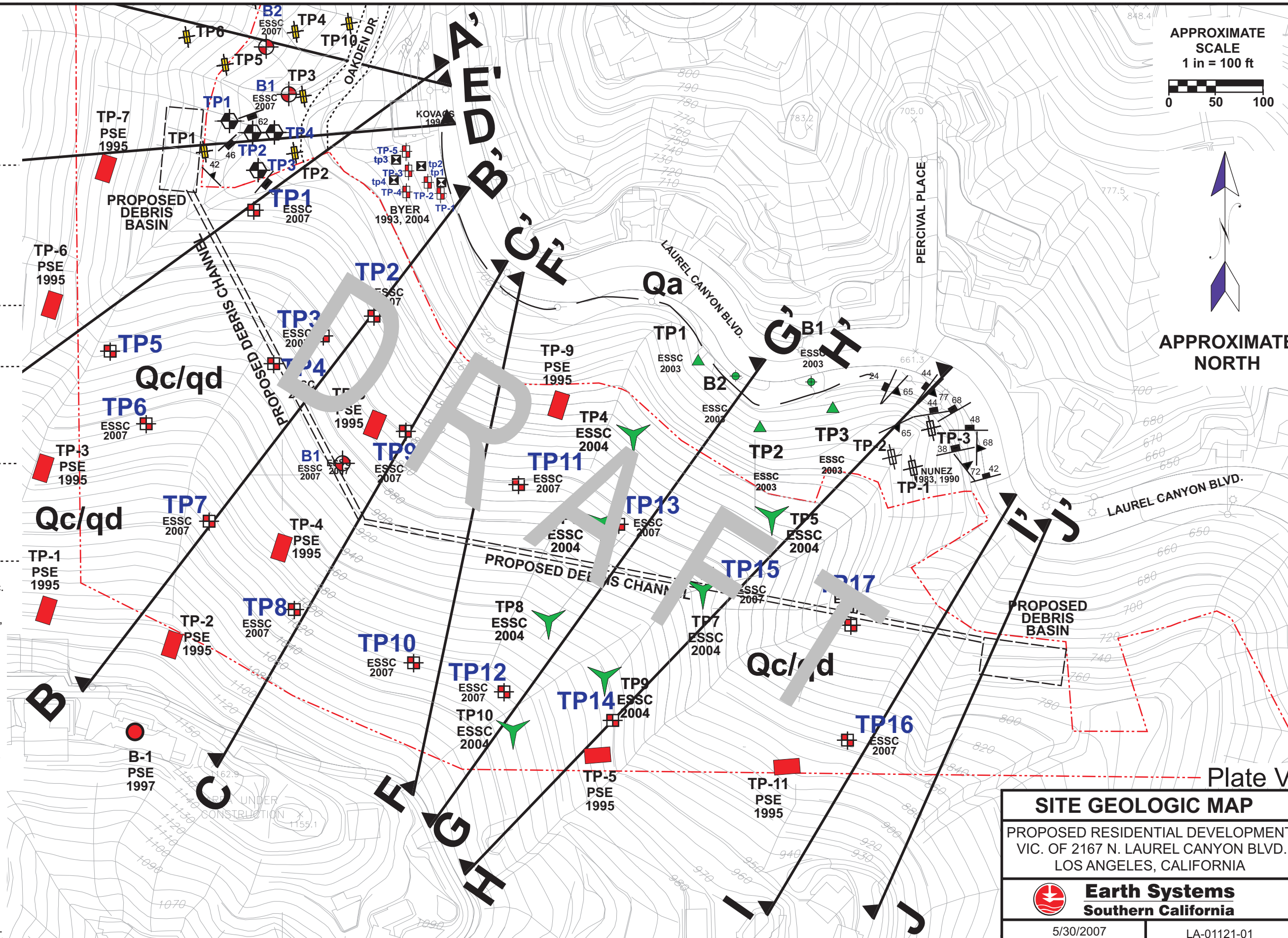

SITE GEOLOGIC MAP

PROPOSED RESIDENTIAL DEVELOPMENT
VIC. OF 2167 N. LAUREL CANYON BLVD.
LOS ANGELES, CALIFORNIA



5/30/2007

LA-01121-01